

Clamp Levers with external thread



Material:

Handle in die cast zinc to DIN 1743, steel parts quality class 5.8

Surface finish:

Handle plastic-coated, steel parts black oxide finish

Note:

Standard colours are:
black satin finish, orange RAL 2004

Other colours available on request.
Other materials, surface finishes, special versions, etc. are available.

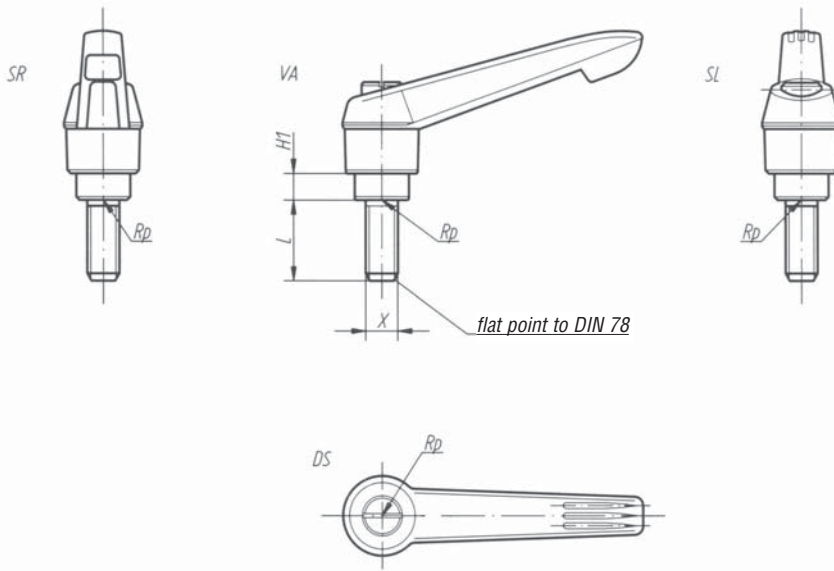

Clamp Levers with external thread

Order No. black satin finish	Order No. orange	Size	External thread X**	H1*	L = Screw length **													
50 105*** 01	50 105*** 02	1	M 5	4	10	15	20	25	30	35	40	45	50	-	-	-	-	-
50 106*** 01	50 106*** 02	1	M 6	4	10	15	20	25	30	35	40	45	50	-	-	-	-	-
50 206*** 01	50 206*** 02	2	M 6	6,5	-	15	20	25	30	35	40	45	50	55	60	-	-	-
50 208*** 01	50 208*** 02	2	M 8	6,5	-	15	20	25	30	35	40	45	50	55	60	-	-	-
50 210*** 01	50 210*** 02	2	M 10	6,5	-	15	20	25	30	35	40	45	50	55	60	-	-	-
50 310*** 01	50 310*** 02	3	M 10	10	-	15	20	25	30	35	40	45	50	55	60	-	-	-
50 410*** 01	50 410*** 02	4	M 10	10	-	-	20	25	30	35	40	45	50	55	60	70	80	90
50 412*** 01	50 412*** 02	4	M 12	10	-	-	20	25	30	35	40	45	50	55	60	70	80	90
50 512*** 01	50 512*** 02	5	M 12	12	-	-	-	25	30	35	40	45	50	55	60	70	80	90
50 516*** 01	50 516*** 02	5	M 16	12	-	-	-	25	30	35	40	45	50	55	60	70	80	90

Sample order: Clamp Lever 5031005002
(Length L)

*Dimension "H1" available in other lengths at extra charge **Other external threads and screw lengths available on request
***Add the desired screw length here, e.g. 050 for L = 50 mm

Clamp Levers with external thread, steel parts in stainless steel



Material:

Handle in die cast zinc to DIN 1743, steel parts in stainless steel, X 10 CrNiS 18 9 = 1.4305

Surface finish:

Handle plastic-coated, steel parts natural finish

Note:

Standard colours are:
black satin finish, orange RAL 2004

Other colours available on request.
Other materials, surface finishes, special versions, etc. are available.

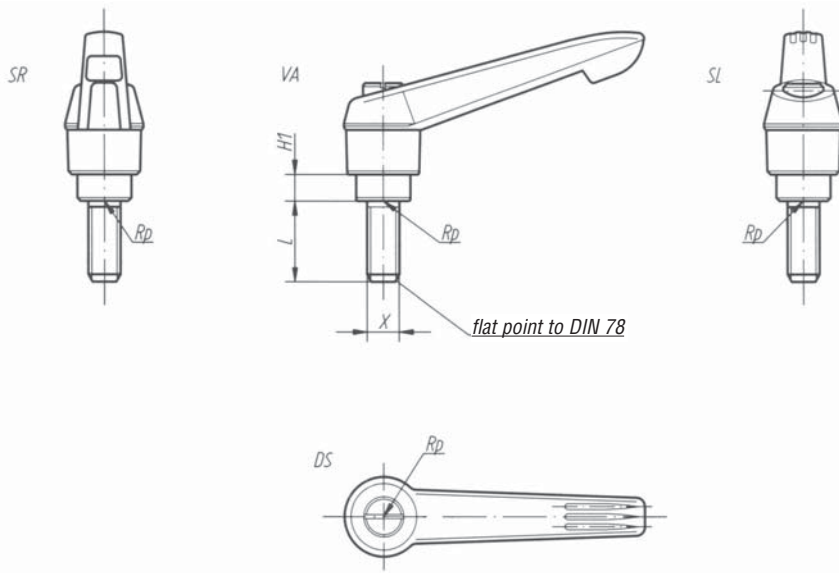

Clamp Levers with external thread, steel parts in stainless steel

Order No. black satin finish	Order No. orange	Size	External thread X**	H1*	L = Screw length **							
50 105*** 01 OS0 50 105*** 02 OS0		1	M 5	4	-	15	20	25	-	-	-	-
50 106*** 01 OS0 50 106*** 02 OS0		1	M 6	4	10	15	20	25	30	40	50	-
50 206*** 01 OS0 50 206*** 02 OS0		2	M 6	6,5	-	15	20	25	30	40	50	60
50 208*** 01 OS0 50 208*** 02 OS0		2	M 8	6,5	-	15	20	25	30	40	50	60
50 210*** 01 OS0 50 210*** 02 OS0		2	M 10	6,5	-	-	20	25	30	40	50	60
50 310*** 01 OS0 50 310*** 02 OS0		3	M 10	10	-	-	20	25	30	40	50	60
50 412*** 01 OS0 50 412*** 02 OS0		4	M 12	10	-	-	-	25	30	40	50	60
50 516*** 01 OS0 50 516*** 02 OS0		5	M 16	12	-	-	-	-	30	40	50	60

Sample order: Clamp Lever 50310050020S0
(Length L)

* Dimension "H1" available in other lengths at extra charge **Other external threads and screw lengths available on request
*** Add the desired screw length here, e.g. 050 for L = 50 mm